

# Laminar Flow Cabinets

## Introduction

Laminar Flow Cabinets are designed to protect the work surface, products and materials from particulate contamination. Room air passes through a HEPA filter then uniformly by laminar flow through the cabinet interior to protect the work from unfiltered air. The airflow is oriented to exhaust airborne particulate introduced by the user.

## Features

- Vertical laminar flow with HEPA/ULPA filtration protects materials inside the cabinet from particulates.
- High airflow capacity.
- Configurable with a broad range of options customized to your specific application.
- Easy-to-change filters.
- Available in 2', 3' and 4' widths.

### CONVENIENCE AND CONSTRUCTION BENEFITS:

- Laminar Flow Cabinets are available in three model sizes with various options.
- Products are designed for desktop use, or may be installed on an optional base stand or mobile cart.
- Laminar Flow Cabinets maintain a 0.45 m/s (90 fpm) airflow velocity, measured 6" (150 mm) from the filter face, with a uniformity of +/- 20% across the filter face.
- This face velocity is in compliance with U.S.A. and international standards for safety and performance. The HEPA filters are easy to replace; no tools required.
- Laminar Flow Cabinets are constructed of steel with a microbial powder finish coating.



- FLOW24



### AIRFLOW PATTERN: LAMINAR FLOW CABINET

**A. Exhaust Air**

**B. Fan / Blower**

**C. Electrostatic Pre-filter:**  
Pre-filter may be changed from below the work surface while unit is running

**D. Main Filters**

**E. Room Air Intake**

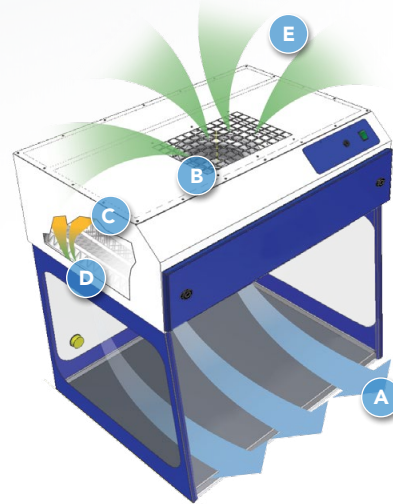

**Provides the Finest Operator Safety in the World**

Compliant with OSHA, ANSI and other International Standards



# LAMINAR FLOW CABINETS

This Product Exceeds OSHA, ANSI and Other International Standards.

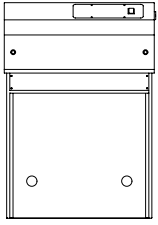

FLOW24

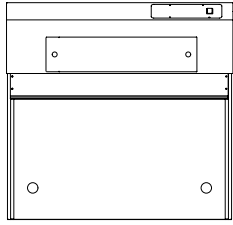

FLOW36

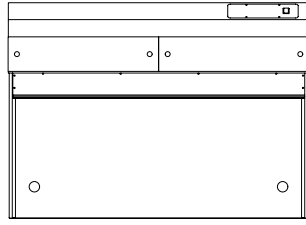

FLOW48

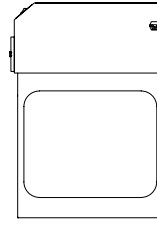

Side View

MODEL	DIMENSIONS			WEIGHT (lbs/Kg)	
	Internal Height	External (W x D x H)	Shipping (W x D x H)	Net	Ship
<b>Standard Models</b>					
FLOW24	24" / 610 mm	24" x 24" x 35" / 610 x 610 x 889 mm	40" x 40" x 40" / 1016 x 1016 x 1016 mm	72 / 33	129 / 59
FLOW36	24" / 610 mm	36" x 24" x 35" / 915 x 610 x 889 mm	40" x 40" x 40" / 1016 x 1016 x 1016 mm	99 / 45	157 / 71
FLOW48	24" / 610 mm	48" x 24" x 35" / 1220 x 610 x 889 mm	52" x 45" x 40" / 1321 x 1143 x 1016 mm	138 / 63	195 / 88

Specifications are subject to change without notice.

## PRODUCT SPECIFICATIONS

Model	FLOW24	FLOW36	FLOW48
Airflow Pattern	Vertical downflow.		
Airflow*	0.45 m/s (90 fpm).		
Side Windows	Acrylic, transparent, colorless.		
Construction	White epoxy-coated steel frame with blue legs on cabinet sides.		
Pass Through Ports	Standard.		
Blower	ebmpapst™ centrifugal fan.		
Electrical	120V, 60Hz or 220V, 50Hz voltages available. Specify when ordering. Other voltage options available.		
Electrical Controls	Main ON/OFF switch for fan and lighting. Solid-state fan speed control with RFI filter maintains blower uniformity.		

### Filter System Specifications

Pre-Filter	Camfil Farr filters; HEPA efficiency, 99.99% at 0.3µm.
Main**	HEPA efficiency, 99.99% at 0.3 µm.
Clamping	Screw compression clamp.
Lighting	Compact fluorescent bulb, removed from air stream.

### Standard Accessories

Base Stand	Floor-standing base for cabinet. Available with leveling feet or locking casters. Optional motorized height adjustment.
ULPA Filter	ULPA filter efficiency 99.999% at particle sizes between 0.1 to 0.3 µm.
Spill Tray/Work Surface	Polypropylene work surface available in white or black. Slides out for easy cleaning.

\* Average airflow measured 6" (150 mm) from filter face. Uniformity is +/- 20%.

\*\* Camfil Farr filters; HEPA efficiency, 99.99% at 0.3 µm.